



**IEEE P1904.1 SIEPON Working Group
Meeting Information for February 19-21, 2013
Okinawa, Japan**

1. Meeting dates

February 19, 2013(Tuesday) – February 21, 2013(Thursday): whole day

2. Meeting location

2.1 Venue

Hotel Nikko Naha / Grand Castle

Address:

1-132-1, Yamakawa-cho, Shuri, Naha—Shi, Okinawa

Tel: +81-98-886-5454

Fax: +81-98-886-1277

Website:

<http://www.jalhotels.com/domestic/okinawa/grandcastle/index.html>



2.2 Location

Hotel Nikko Naha/Grand Castle is an affordable luxury hotel located on the top of the historical Shuri Hill in the beautiful ancient city of Naha.

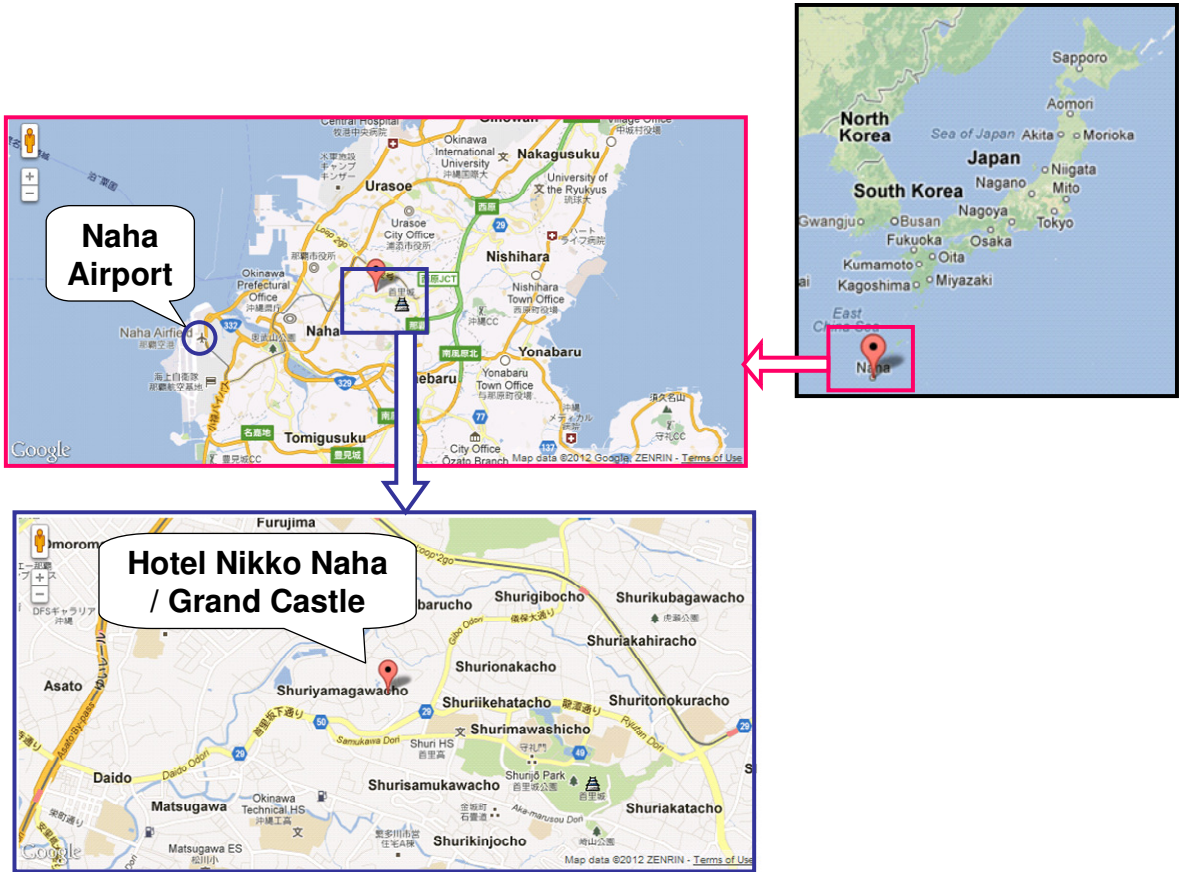

2.3 Meeting room

The meeting is held at room “Koufuku”, at 2nd floor of the hotel.

The reception is at the front of the room, and you can receive your name badge there.

2nd Floor map of the Hotel Nikko Naha / Grand Castle

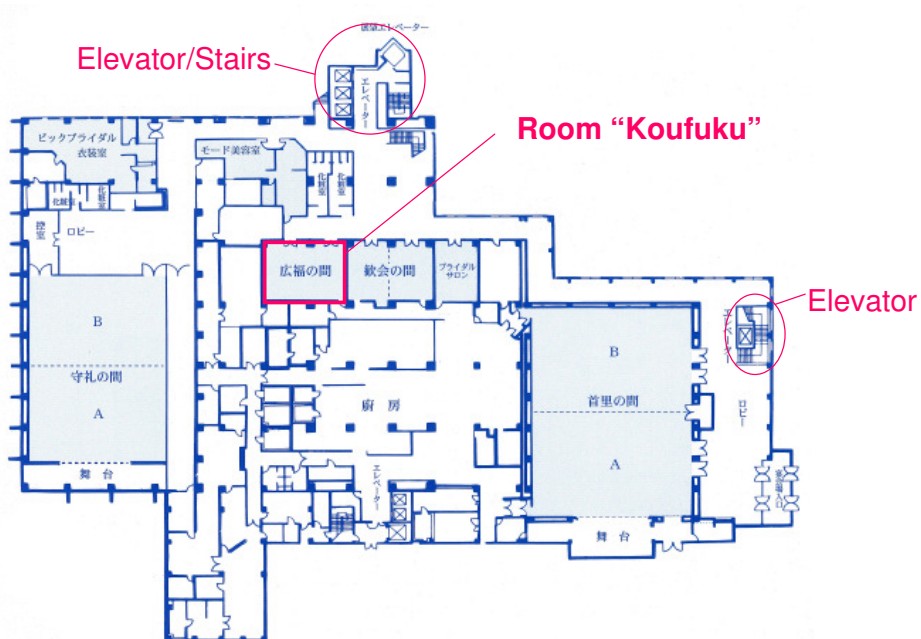

3. Transportation from Naha airport(OKA) to the Hotel Nikko Naha / Grand Castle

3.1 Taxi

- 2,500 JPY
- 30min.

Taxi is available from the airport. Showing below map to the taxi driver should be recommended.

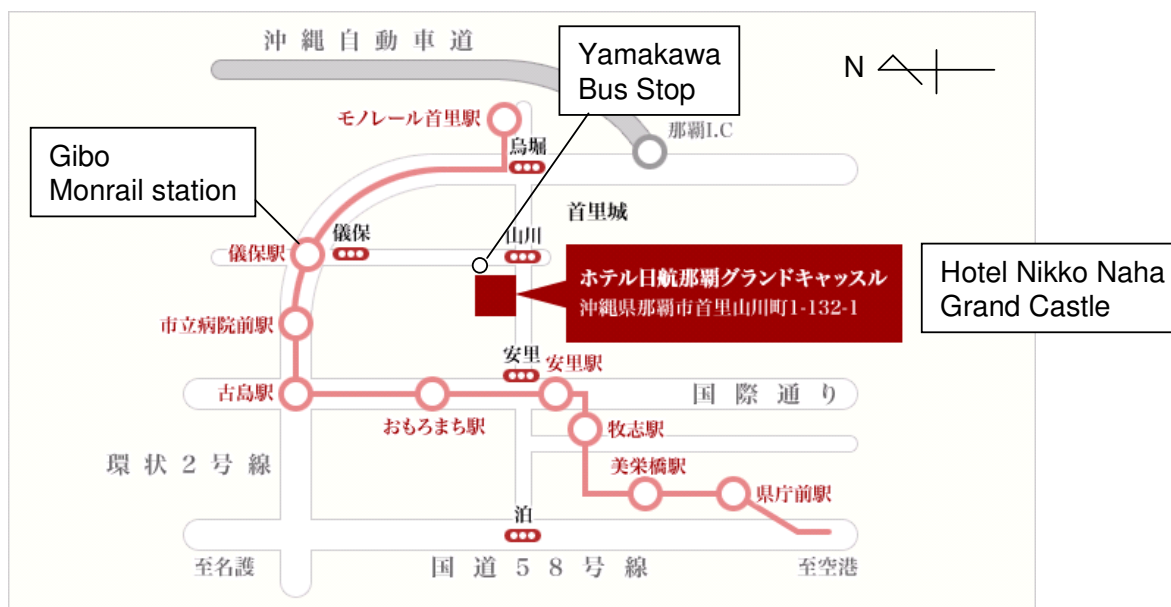

3.2 Bus

- 220 JPY
- 30min.

Take the **No.25 Bus** at the airport and get off at **Yamakawa bus stop**, 5 minutes walk to the hotel.

3.3 Train (Monorail)

- 320 JPY
- 50min.

Take the monorail bound for Shuri, get off at **Gibo station**, and 15 minutes walk to the hotel.

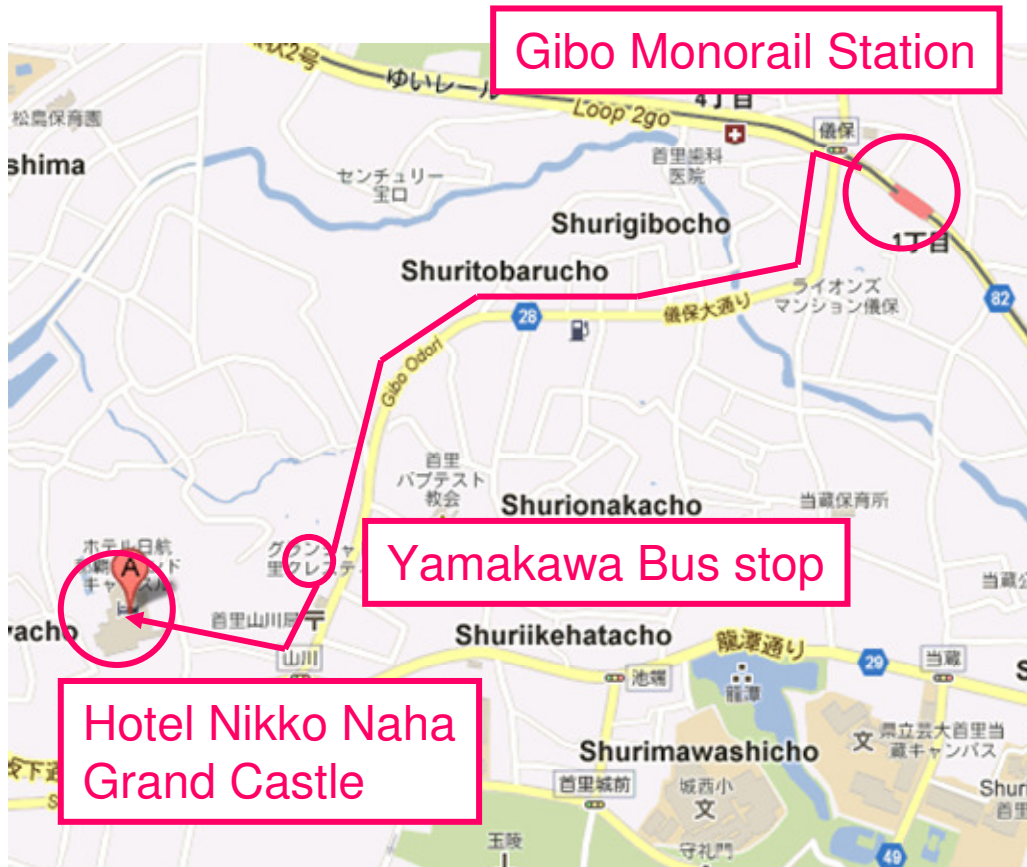

4. Hotel Reservations

4.1 Room

Deluxe Twin Room: 11275 JPY per room per night with wireless internet access and breakfast.



Please make your reservation before January 31, 2013 to guarantee your room. For reservation, please contact below mail address directly mentioning “NEC IEEE P1904.1 meeting on Feb. 19 – Feb 21” to get special rate.

Phone: +81-98-886-5474

Fax: +81-98-887-0070

E-mail: kenji.kamio@hotelnikkonaha.co.jp

The following information is necessary.

- Name
- Gender
- Check in date
- Check out date
- Smoking or non smoking
- Credit card number

4.2 Check-in/out

Check-in/Check-out Time:

Check in: 2:00 pm

Check out: 11:00 am

4.3 Cancellation Policy

On the day before arrival: 20% of the accommodation fees

On the day of arrival: 80% of the accommodation fees

No show: 100% of the accommodation fees

5. Meeting Registration

Website for meeting registration will be announced soon.

Registration fees for all attendees:

200 USD per attendee if registered on or before January 19, 2013.

300 USD per attendee if registered after January 19, 2013.

6. Hotel Meals

Meeting host will provide lunch during meeting.

Breakfast will be provided for attendees staying the Hotel Nikko Naha / Grand Castle.

Both breakfast and lunch is served at the room "Serena",

1 USD = 82.4 JPY

1 EUR = 106.5 JPY

1 CNY (RMB) = 13.2 JPY

1 ILS = 21.4 JPY

11. Tipping

In Japan, tipping is neither customary nor expected.

12. Time Zone

GMT +9, Daylight saving time is not introduced.

13. Language

Some Japanese people can speak English, and there are some signs in English.

14. Weather of Okinawa

In February, it's warm and comfortable in Okinawa. The temperature is about 18C(64F) in average.

15. Contact

If you have any questions about the meeting arrangements or require any assistance, please don't hesitate to contact:

Sadaichiro Ogushi

E-mail s-oogushi@ax.jp.nec.com

Phone +81-4-7185-7523